

# SUB MACHINE GUN



CO2 Cartridge is not included  
12g  
MADE IN TAIWAN

## AAKCCF07 系說明書 AAKCCF07 INSTRUCTION MANUAL

**KWC** KWIEN WELL TOY INDUSTRIAL CO., LTD  
www.kwcgun.com

台南市仁德區義林路168巷89號  
NO.89, LN. 168, YILIN RD.,  
RENDE DIST., TAINAN CITY  
71752, TAIWAN (R.O.C.)  
TEL : +886-6-2798175  
sales@kwcgun.com  
www.kwcgun.com



## 操作/OPERATION

### 操作說明

#### OPERATION

- 取出彈匣  
RELEASE MAGAZINE



- ▲注意: 請勿使彈匣直接掉落地面, 以防止變形或損壞。
- ▲CAUTION: Magazine directly falling on ground could cause deform or damage on it. Please be aware.

- CO2小鋼瓶的使用

INSTALLING 12G CO2 CARTRIDGE  
逆時針轉出旋塞後, 置入小鋼瓶B, 再以順時針方向鎖緊旋塞A。當刺破鋼瓶出氣時, 請快速鎖緊。  
Turn the magazine cap out counter-clockwise and place CO2 cartridge B inside the magazine. Rapidly turn the screw A clockwise when piercing the cartridge in the magazine.

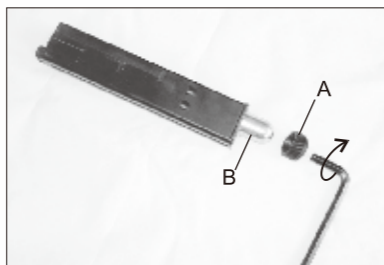

- ▲注意: 為維護彈匣使用壽命, 請盡可能不要殘留CO2氣體於彈匣內。
- ▲CAUTION: To protect your magazine, please release all of the CO2 out of the magazine after every use.

- 填裝B.B彈  
LOADING BBs  
彈匣最多可裝39發B.B彈, 如強行裝入更多, 可能造成不當損壞及無法上膛, 請注意。  
BB's max capacity is 39 rounds. If you load more than this quantity, you would bring any abnormal problems.



- 彈匣上膛  
INSERTING THE MAGAZINE  
將裝好B.B彈的彈匣插入槍身上推入, 直到彈匣卡榫發出“卡嗒”為止。  
Insert fully loaded magazine in the airsoft until you hear the sound of “CLICK”.

- B.B彈上膛  
CHAMBERING THE BB  
將上蓋往後拉到底, 放開拉柄則拉柄會自動回位, 同時亦將B.B彈送上膛完成射擊準備。  
Pulling the slide back. When the slide has been pulled completely back, release the slide without pushing and the BBs will be chambered.

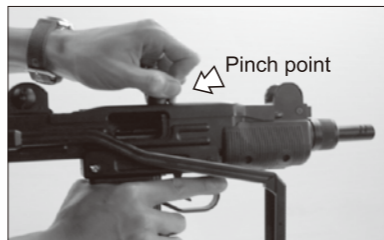

- ▲注意: 拉動上蓋時, 請勿將手指扣住扳機, 以免發生不當射擊, 造成危險。
- ▲CAUTION: The gun is now cocked and will fire when the trigger is pulled. Be careful not to fire accidentally.

- 單/連發和保險切換  
SWITCH SEMI AUTO AND FULL AUTO



- A: 連續射擊 R: 單發射擊 S: 關保險
- A: Full auto R: Semi auto S: Safety

- 握柄保險  
GRIP SAFETY



- ▲注意: 在沒有握住握柄保險的情況下, 是無法射擊的。
- ▲CAUTION: This firearm can't be shot without holding GRIP SAFETY.

- 射擊  
SHOOTING  
對準目標區後扣下扳機, 則B.B彈將被射擊出去。  
Aim the target and pull the trigger. Then the BB will be shot.



- 前/後準星調整  
ADJUSTABLE FRONT / BACK SIGHT

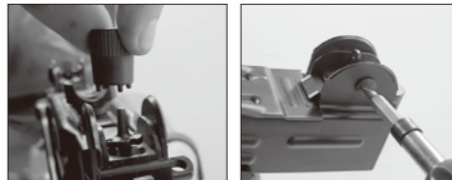

- 前準星調整 FRONT SIGHT
- 後準星調整 REAR SIGHT

- 槍托收折  
STOCK



### 拆解/ DISASSEMBLY

- 按下卡榫, 取出彈匣  
Press the magazine catch to release the magazine.



- 取出上蓋  
TAKE OFF SLIDE

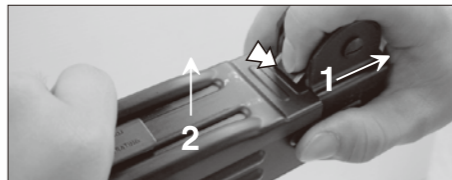

## 故障/BREAK DOWN

- 取出氣缸座  
TAKE OFF CYLINDER UNIT

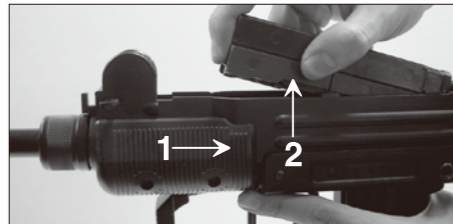

將氣缸座往後拉, 清出B.B彈  
Pull the cylinder back as picture and clean the bb get stuck.



- 槍身上下拆解  
DISASSEMBLE FRAME



- 取出外槍管  
TAKE OFF OUTER BARREL

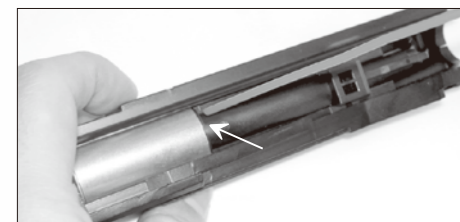
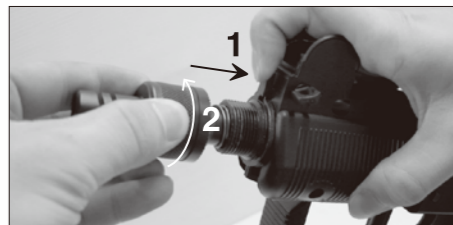

### 故障的原因與排除 BREAK DOWN FAQ

- \* 卡彈可能原因:  
Possible reasons for BB jam:
- a. BB彈排列不整齊  
BB dose not stack properly.
- b. 不良B.B彈  
bad quality BB
- c. 空擊發易造成零件損耗, 請避免此動作。  
please avoid dry firing as it could cause parts deformed or damage.

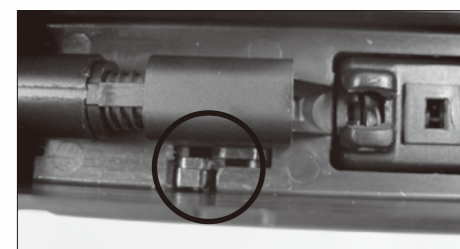



# ⚠️ WARNING 警告

## 請務必嚴格遵守 使用說明指導書

For your safety, please read this manual carefully before use.

此低動能遊戲用槍是針對喜愛射擊運動的消費者所開發。避免因使用方法不正確或改造所發生的故障或事故，請務必詳讀說明書，正確的操作享受愉快的射擊運動。

- 除了發射時外，不要將手指頭掛在板機上。
- 選擇安全與適當標靶
- 在非使用期間，請保持保險關閉且退彈的狀態，就算在非使用狀態，也要如同其已裝彈。
- 如任何的機械產品，槍的保險也可能失效。即使在保險關閉的狀態下也請小心的操作此槍，請勿將槍口對人。
- 千萬不要對堅硬或平坦表面、水面射擊，以避免跳彈。
- 請妥善保管產品在未成童年孩童無法伸手取得的場所。
- 每次使用前後都應該檢查擋彈物，假如擋彈物表面有磨損失效或是反彈時請停止使用。
- 請使用高品質BB彈，請勿使用①口徑大於6mm②表面不平滑的③重複使用過的BB彈④非本說明書指名的發射物。
- 最高的使用及儲藏CO2小鋼瓶環境為50°C (122°F) 以內，高溫可能會造成CO2小鋼瓶過熱甚至爆炸。
- 檢查任何掉落之槍枝，以確保未影響其功能。

**This airgun is intended for recreational or training purposes. To prevent improper handling, modification or alteration causing malfunction or accident, please read the owner's manual carefully. Enjoy the pleasant shooting experience by proper operation.**

- Do not put your finger on the trigger except shooting.
- Please choose safe and proper target.
- Please always keep the airsoft on safe and unloaded when not using.
- Like all mechanical devices, an airsoft safety can fail. Always handle the airsoft safely even when the safety is "on safe". Never point the airsoft at any people.
- Avoid ricochet. Never shoot at a hard or flat surface or at water.
- Keep the airsoft out of reach for small children.
- Your backstop should be inspected for wear before and after each use. Discontinue use of the backstop if surface shows signs of failure or ricochet.
- Only use high quality BB. Never use ①BB diameter larger than 6mm②BB with unsmoothed surface③reused BB that has been fired④incorrect projectiles not design for this airsoft
- Do not expose CO2 cartridges to heat or store them at temperatures above 50°C (122°F). CO2 cartridges may over heat or explode at temperatures above 50°C (122°F).
- Check any gun that has been dropped to ensure that its function has not been affected.

★使用低動能遊戲用槍前，請務必戴上保護眼鏡或面罩。

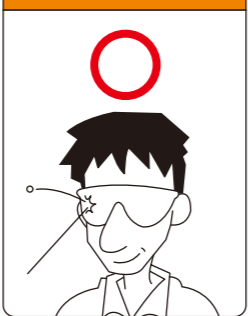

★不可攜帶低動能遊戲用槍在公共場所行走，請務必裝在袋子或盒子內。

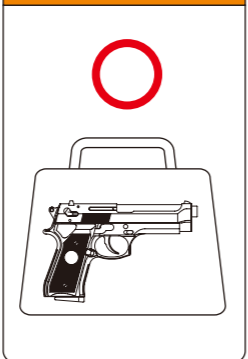

★使用低動能遊戲用槍前，請務必詳讀說明書內容。



★請不要由槍口向內探視。



★請不要在公開場合使用低動能遊戲用槍，也請不要拿低動能遊戲用槍對準人或動物。

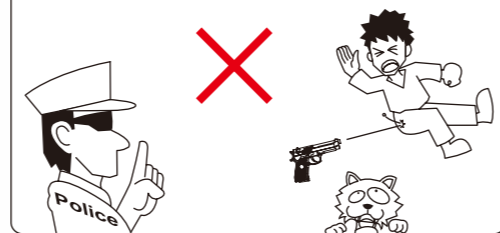

★請確認後再發射BB彈方向，附近無人或動物存在。

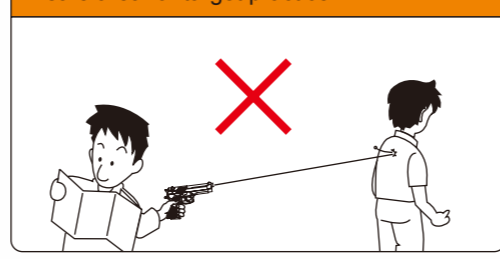

★不可任意改造或加工低動能遊戲用槍，私自改造加工會造成產品損壞、保固失效，導致使用上不安全，甚至觸法送辦。

★Disassemble, modify, or alter of your airgun may cause malfunction, void your warranty and may make it unsafe to use.

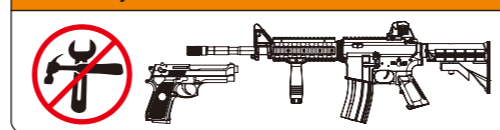

Do not display this pistol in public—it may confuse people and may be a crime. 請不要忘了，雖然自己知道這只是玩具，但不知道的人，會以為這是真槍。

# AAKCCF07 系列 零件表 AAKCCF07 SERIES PARTS LIST

NO.	零件名稱	UNIT	NO.	零件名稱	UNIT	NO.	零件名稱	UNIT
P01	本體(連發用)	FRAME	102	滑套射嘴後部	REAR LOADING NOZZLE	S12	握柄保險壓簧	GRIP SAFETY SPRING
P02	槍身下部	LOWER FRAME	107	撞針定位件	FIRING PIN LOCATOR	S13	撞針扭簧	FIRING PIN SPRING
P03	彈匣滑粒	MAGAZINE FOLLOWER	201A	氣缸本體(左)	CYLINDER (L)	S16	彈匣壓簧	MAGAZINE SPRING
P04	彈匣底座定位件	MAGAZINE BASE LOCATOR	202A	氣缸本體(右)	CYLINDER (R)	S18	擊鏈卡棒扭簧	HAMMER CATCH SPRING
P05	槍管卡榫	BARREL CATCH	203	擊鏈卡榫	HAMMER CATCH	S19	扳機扭簧	TRIGGER SPRING
P07	槍柄(左)	GRIP (L)	204	槍管接筒	BARREL CONNECTOR	S20	心棒壓簧	VALVE SPRING
P09	HOP-UP調整片	HOP-UP ADJUSTOR	205	本體固定件	FRAME FIXTURE	S21	防雙進彈扭簧	ANTI DOUBLE LOADING SPRING
P10	彈匣滑粒配件	MAGAZINE FOLLOWER ACCESSORY	206	氣缸後配件	REAR CYLINDER ACCESSORY			
P11	護木(左)	HAND GURAD (L)	301D	氣缸	CYLINDER	SM2	氣缸回位壓簧	CYLINDER RECOIL SPRING
P12	護木(右)	HAND GURAD (R)	302B	射嘴壓簧導件	LOADING NOZZLE SPRING GUIDE	SM5	氣流控制件壓簧(前)	FLOATING VALVE SPRING(FRONT)
P13	槍柄(右)	GRIP (R)	304C	氣缸本體導桿	CYLINDER GUIDE			
P17	氣嘴迫緊配件	GAS ROUTE PACKING ACCESSORY	305B	氣缸本體導桿套	CYLINDER GUIDE SLEEVE	C07	HOP-UP調整件壓簧	HOP-UP ADJUSTOR SPRING
P18	裝彈器	SPEED LOADER TUBE	306	氣缸本體固定件	CYLINDER LOCKER	R02	子彈迫緊 HOP-UP	RUBBER CHAMBER
P19	槍身上蓋配件	UPPER FRAME ACCESSORY	307	氣缸本體緩衝件	CYLINDER BUMPER			
P21	槍管配件	BARREL RING	311	射嘴回位壓簧配件	LOADING NOZZLE RECOIL SPRING GUIDE	G008	O形環 1X6	O-RING 1X6
P22	防雙進彈扭簧配件	ANTI DOUBLE LOADING SPRING ACCESSORY	324	滑套射嘴墊圈	LOADING NOZZLE RING	G016	O形環 PU S-4(黃)	O-RING PU S-4
P31	裝彈槽套B	BB LOADER GROOVE	403	回位緩衝件華司	RECOIL BUFFER WASHER	G027	O形環 S-15	O-RING S-15
P32	通條套頭	HEAD-PRESS ROD	501	氣嘴迫緊	GAS ROUTE PACKING	G032	O型環 P-7	O-RING P-7
P41	心棒迫緊	VALVE PACKING	603	射嘴回位壓簧	LOADING NOZZLE RECOIL SPRING	G037	O形環 2X12	O-RING 2X12
P45	分流控制件	GAS GUIDE VALVE	605	氣缸緩衝壓簧	CYLINDER BUFFER SPRING	G039	O形環 2X15 橘紅色	O-RING 2X15
P52	滑套射嘴前部(寬)	FRONT LOADING NOZZLE	609	彈匣卡榫扭簧	MAGAZINE CATCH SPRING			
KMB07-P52	氣流控制件	FLOATING VALVE				F01	後準星彈片	REAR SIGHT SPRING
KA11-F07	KA11軸B(擊鐵箱)(鉸)	PIN#B-CHASSIS	B03	扳機軸	TRIGGER PIN	F04	單連發控制桿	FULLSEMI SWITCH PLATE
KG12-P60	彈匣底內件	MAGAZINE BOTTOM CAP	B05	前準星定位銷	FRONT SIGHT LOCATORPIN	F05	彈匣底座	MAGAZINE BASE
KG15-F03	彈匣底內件配件	MAGAZINE BOTTOM CAP ACCESSORY	B09	外槍管(無攻牙)	OUTER BARREL (NON-THREAD)	F06	拉柄滑件	COCKING HANDLE PLATE
Z06	槍托座	STOCK BASE	B10	擊鏈卡榫軸	HAMMER CATCH PIN	F07	保險定位彈片	SAFETY LOCATOR SPRING
Z09	前準星	FRONT SIGHT	B11	內槍管	INNER BARREL	F11	撞針	FIRING PIN
Z10	槍托	STOCK	B12	後背帶銷	REAR STRAP PIN			
Z11	撞針本體	FIRING PIN FRAME	B13	前背帶扣	FRONT STRAP BUCKLE	EA002	六角螺帽 M3X6.0 通黑熱	HEX NUT M3X6.0
Z14	彈匣卡榫	MAGAZINE CATCH	B15	彈匣卡榫軸	MAGAZINE CATCH PIN	EA007	槍柄螺絲 一字M3.0X26黑	GRIP SCREW M3.0X26
Z15	後準星	REAR SIGHT	B16	後準星螺絲	REAR SIGHT SCREW	EA035	螺絲 田M2.6X8銀	SCREW M2.6X8
Z16	扳機	TRIGGER	B18	拉柄螺絲	COCKING HANDLE SCREW	EA072	螺絲 田M2.6X8鉸	SCREW 2.6X8
Z17	扳機運動件	TRIGGER CONNECTOR	B19	槍身下部軸	LOWER FRAME PIN	EA074	螺絲 田M3X6	SCREW M3X6
Z22	握柄保險	GRIP SAFETY	B23	扳機連動件軸	TRIGGER CONNECTOR PIN	EA081	螺絲 內六角M3X8黑	SOCKET SCREW M3X8
Z26	槍管定位件	BARREL LOCATOR	B24	後準星彈片軸	REAR SIGHT SPRING PIN	EA090	螺絲 內六角M3.0X6黑	SOCKET SCREW M3.0X6
Z27	槍管定位件配件	BARREL LOCATOR ACCESSORY	B28	氣瓶頂針(逆牙)	PUNCTURE VALVE	EA092	螺絲 內六角M3.0X10黑	SOCKET SCREW M3.0X10
Z28	槍身內套	INNER FRAME SLEEVE	B31	氣閥本體	VALVE FRAME	EA099	止付螺絲 M2.0X6黑	SET SCREW M2.0X6
Z29	槍身上蓋	SLIDE	B32	心棒後部	VALVE REAR	EC007	彈簧銷	SPRING PIN
Z30	拉柄座	COCKING HANDLE BASE	B33	心棒	VALVE	ED005	E型扣環	E-RING #005
Z31	拉柄	COCKING HANDLE	B215	氣瓶頂針迫緊	PUNCTURE VALVE PACKING	ED006	E型扣環	E-RING #006
Z32	前準星座	FRONT SIGHT BASE	S01	撞針定位件壓簧	FIRING PIN LOCATOR SPRING	EF007	軸(鉸)	PIN #EF007
Z33	單連發切換件	FULL/SEMI SWITCH	S02	槍管定位件壓簧	BARREL LOCATOR ACCESSORY SPRING	X01	通條	PRESS ROD
Z34	上蓋卡榫	SLIDE CATCH	S03	槍管定位件壓簧	BARREL LOCATOR SPRING	X02	透明管	TUBE-PRESS ROD
Z35	前準星調整鈕	FRONT SIGHT ADJUST TOOL	S04	前準星定位銷壓簧	FRONT SIGHT LOCATOR PIN SPRING			
Z36	握柄保險連桿	GRIP SAFETY BAR	S05	拉柄回位拉簧	COCKING HANDLE RECOIL SPRING	U1	內槍管組件	INNER BARREL UNIT
Z37	後準星螺帽	REAR SIGHT NUT	S08	上蓋卡榫壓簧	SLIDE CATCH SPRING	U2	氣閥組件	VALVE UNIT
			S09	後背帶銷壓簧	REAR STRAP PIN SPRING	U3	氣瓶頂針組件	PUNCTURE VALVE UNIT

# AAKCCF07 系列 零件分解圖 AAKCCF07 SERIES EXPLODED VIEW

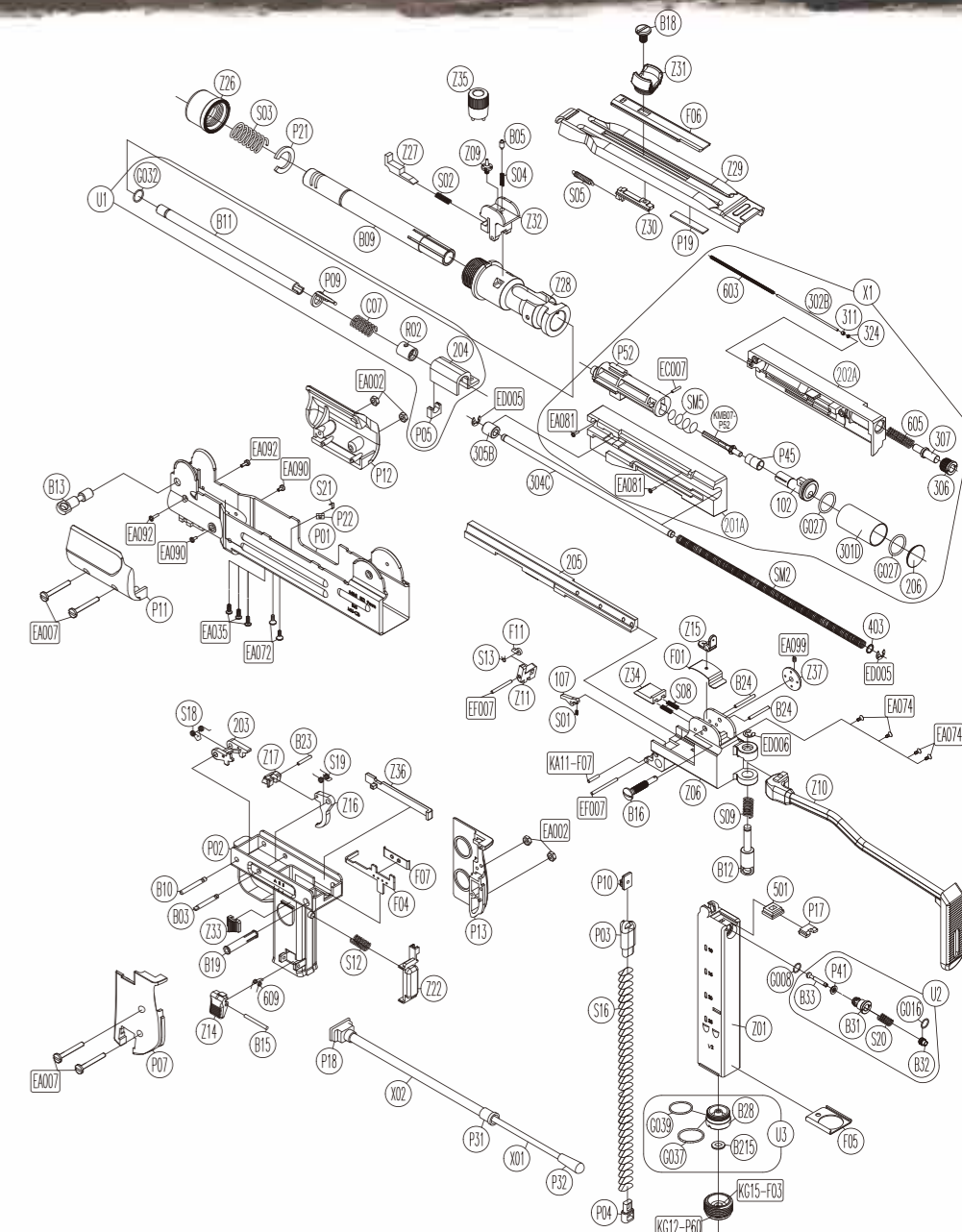

※零件有時為了改良而不經預告變更。  
Spare parts may be modified for quality improvement  
And such modification may be without advance notice.